

Disc Brake

BR-MT410 Brake Caliper

SM-BH59-JK-SS Brake Hose

SM-RT54 Disc Rotor/Center Lock

SM-RT56 Disc Rotor/6-Bolt

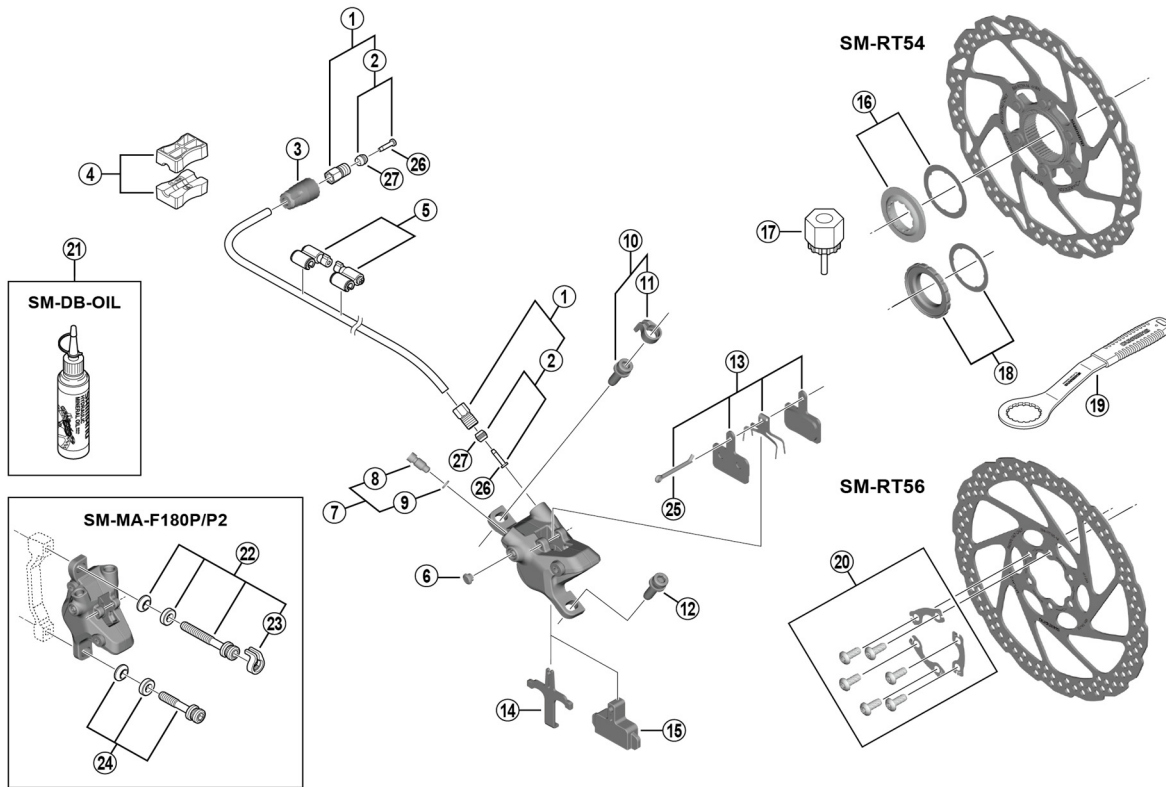

BR-MT400

ITEM NO.	SHIMANO CODE NO.	DESCRIPTION	INTERCHANGEABILITY	
1	Y8M998010	Flare nut unit	A	
2	Y8H298040	Olive and connector insert	A	
3	Y8WM14000	Cover	A	
4	Y8H198030	TL-BH61 Shimano original tool (2 pcs.)	A	
5	Y83098040	SM-HANG Hose supporter A and B	A	
6	Y88F06000	Bleed boss cap	A	
7	Y8LS98030	Bleed screw and O-ring	A	
8	Y8VZ07000	Bleed screw	A	
9	Y8B511001	O-ring	A	
10	Y2F398020	Caliper fixing screw (M6 x 18.7) and snap ring	A	
11	Y2RT06000	Snap ring	A	
12	Y8C509020	Caliper fixing screw (M6 x 18.7)	A	
*	EBPB05SRXA	B05S-RX Resin pad and spring with split pin 3 type (pair)		
* 13	EBPB05SRXBS	B05S-RX Resin pad and spring with split pin 3 type (25 pairs)		
*	EBPB05SRXCS	B05S-RX Resin pad and spring with split pin 3 type (50 pairs)		
14	Y8PE03000	Pad spacer	A	
15	Y8FZ05000	Bleeding spacer	A	
16	Y8KU98010	Lock ring (black) and washer		
17	Y12009230	TL-LR15 Lock ring removal tool	A	
18	Y24698030	Lock ring and washer (external spline type)		
19	Y13098000	TL-FC36 Lock ring removal tool	A	
20	Y8KT98010	Rotor fixing screw and lock washer		
21	Y83998020	Mineral oil (100 ml)	A	
	Y83998030	Mineral oil (500 ml)	A	
22	Y2RT98020	Caliper fixing screw unit (M6 x 37.9)	A	
23	Y2RT07000	Snap ring	A	
24	Y8G498030	Caliper fixing screw unit (M6 x 32.1)	A	
25	Y8DB06100	Split pin	A	
* 26	Y8H298046	Connecting insert (100 pcs.)		
* 27	Y8H298047	Olive (100 pcs.)		

A: Same parts.

B: Parts are usable, but differ in materials, appearance, finish, size, etc.

Absence of mark indicates non-interchangeability.

Specifications are subject to change without notice.

Feb.-2022-4663D

© Shimano Inc. I

SHIMANO